

Cylindrical Mount

ECO-SERIES PUFFER C

Properties

- shock-isolating buffers with female thread on both sides
- extremely versatile supports used in a wide range of applications
- quick and easy assembly
- in many cases makes up for the missing measures of the premium series

Applications

- elastic fixation and shock-isolating mounting of small to midsize equipment units such as electric motors, internal combustion engines, compressors, pumps, measuring devices, switchboards, control panels, instruments generally



Code - 2FF...

Material - Rubber/Metal

Hardness - 40 ÷ 65 °shore A

ITEM TYPE C	Ø d	h	g	l
	mm	mm		mm
F/F	15	15	M4	4
F/F	15	15	M4	4
F/F	15	15	M4	4
F/F	20	20	M6	6
F/F	20	25	M6	6
F/F	25	15	M6	6
F/F	25	30	M6	6
F/F	30	20	M8	6
F/F	30	30	M8	8,5
F/F	40	30	M8	10
F/F	40	40	M8	10
F/F	50	30	M10	10
F/F	50	45	M10	10
F/F	50	45	M10	10
F/F	60	50	M12	9
F/F	70	40	M10	10
F/F	70	45	M10	10
F/F	75	50	M12	13
F/F	100	40	M16	14
F/F	100	55	M16	16

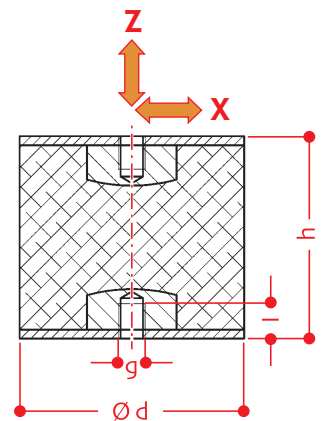

ATAG reserves the right to make changes without notice, by virtue of any quality improvements and/or product specifications • apr_19 rdb