

Cylindrical Mount

# ECO-SERIES PUFFER B

**Properties**

- shock-isolating buffers with female thread and threaded stud
- extremely versatile supports used in a wide range of applications
- quick and easy assembly
- in many cases makes up for the missing measures of the premium series

**Applications**

- elastic fixation and shock-isolating mounting of small to midsize equipment units such as electric motors, internal combustion engines, compressors, pumps, measuring devices, switchboards, control panels, instruments generally



**Code - 2MF...**  
**Material - Rubber/Metal**  
**Hardness - 40 ÷ 65 shore A**

ITEM TYPE B	Ø d	h	g	l <sub>1</sub>	l <sub>2</sub>
	mm	mm		mm	mm
MF	15	15	M4	14	4
MF	15	15	M5	10	3
MF	15	15	M4	14	4
MF	15	15	M4	6	4
MF	15	15	M4	6	7
MF	15	15	M4	10	4
MF	15	20	M4	10	7
MF	15	30	M4	10	7
MF	15	30	M4	14	7
MF	20	15	M6	16	6
MF	25	15	M6	18	6
MF	25	15	M6	18	8
MF	25	20	M6	18	6
MF	25	20	M6	18	6
MF	30	20	M8	18	6
MF	30	20	M8	23	6
MF	30	20	M8	18	6
MF	30	20	M8	23	6
MF	30	30	M8	23	8,5
MF	30	30	M8	23	8,5
MF	40	15	M8	23	8
MF	40	30	M8	23	10
MF	40	40	M8	23	10
MF	40	40	M8	23	10

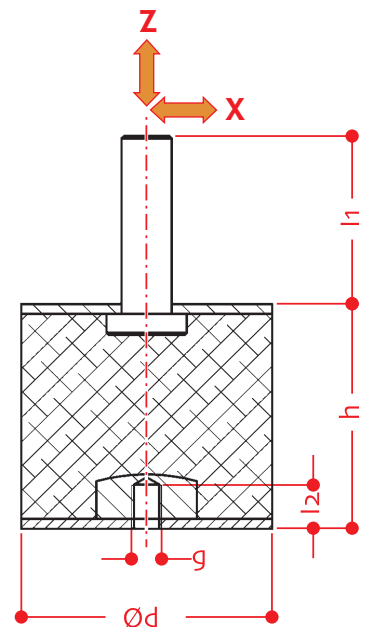

continued on next page

Cylindrical Mount

ECO-SERIES PUFFER B

ITEM TYPE B	Ø d	h	g	l <sub>1</sub>	l <sub>2</sub>
	mm	mm		mm	mm
MF	40	40	M8	23	10
MF	50	20	M10	25	10
MF	50	20	M10	25	10
MF	50	30	M10	25	9
MF	50	30	M10	25	10
MF	50	45	M10	25	10
MF	60	40	M10	25	10
MF	70	45	M10	25	10
MF	75	40	M12	37	13
MF	75	40	M12	37	13
MF	75	40	M12	37	13
MF	75	55	M12	37	13
MF	100	40	M16	47	16

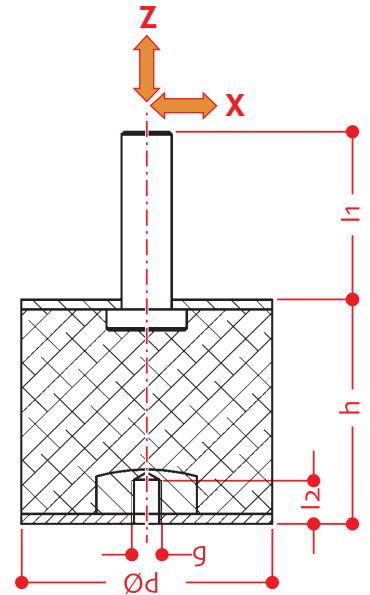

ATAG reserves the right to make changes without notice, by virtue of any quality improvements and/or product specifications • apr\_19 rdb